

FLINTEGE METAL EDGING SET
IN BED OF FLINTBOND OR HOT
ASPHALT; PRIME FLANGE

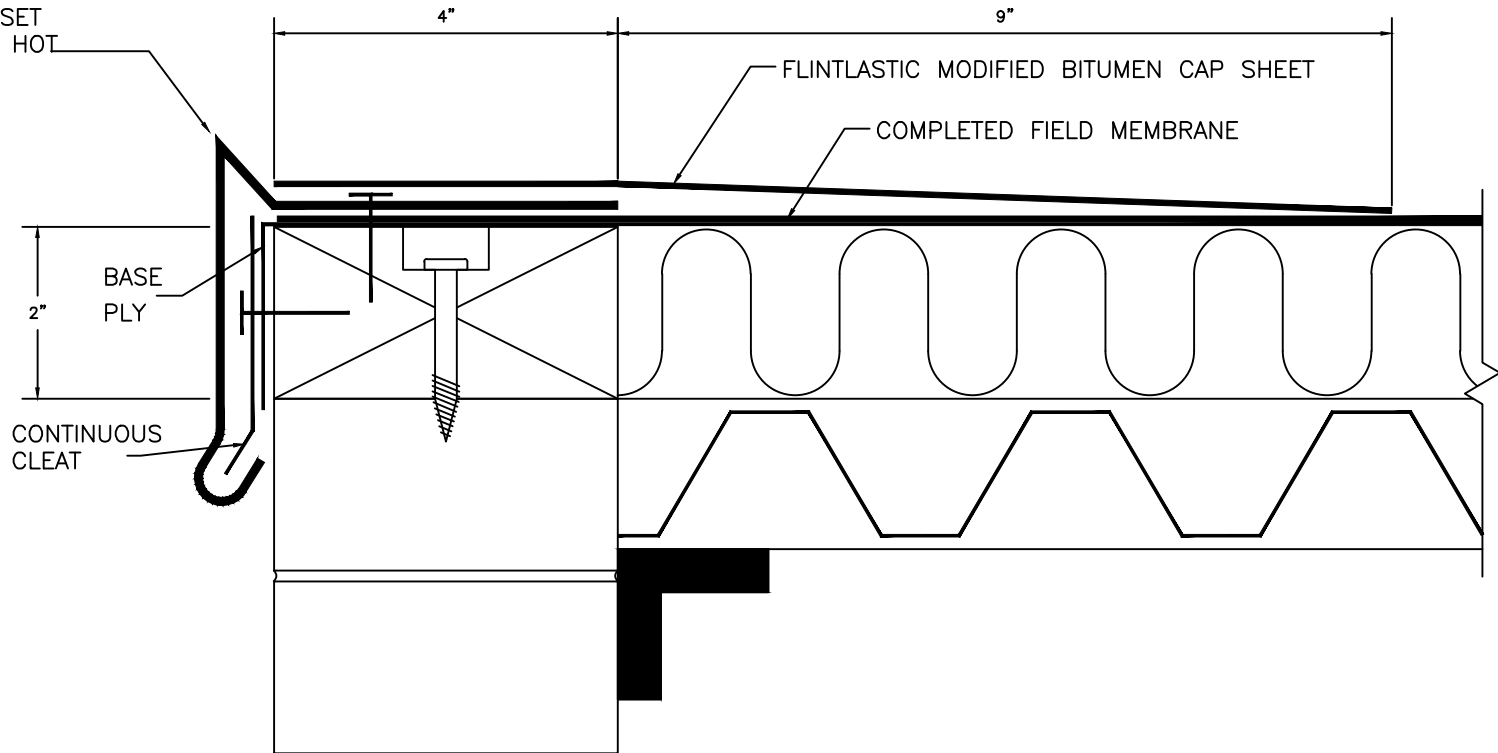

Notes:

1. This detail is appropriate for hot-asphalt, torch-welded, and cold process applications. For self-adhered systems, adapt modifications addressed in Section 5 of Construction Details.
2. Nail the primed metal flange 6" o.c. staggered (end laps shall receive two nails).
3. Metal edging shall have a $\frac{3}{4}$ " rise for gravel surfaced membranes and a $\frac{3}{8}$ " rise for smooth or mineral-surfaced membranes.

CertainTeed
SAINT-GOBAIN

ISSUE DATE
8/19/2013

REVISION
B

DRAWING NUMBER

CT-03

SCALE

Not to Scale

Edge Flashing - Gravel Stop

Commercial Roofing

Sheet 1 of 1